

# Our Place | Ahu Taumatua

## THE REDEVELOPMENT OF PALMERSTON NORTH REGIONAL HOSPITAL

ISSUE 39 | AUGUST 2023

Ahu Taumatua | Our Place brings you all the latest information on the redevelopment projects at Palmerston North Regional Hospital to improve capacity and healthcare in our region.

Learn how our mahi is providing interim solutions and services as we work together to achieve our long-term redevelopment goals to benefit the health of the people in our rohe.

*The concrete foundation of our Acute Mental Health Unit is now complete.*

### INTRODUCTION

During August, all our projects continued to develop well.

A construction crane came onto the Acute Mental Health Unit site to support the installation of the large frames.

The fitout of our new theatres and cath lab is well underway as the SPIRE project enters its last few months of construction.

On 14–16 August a team of architects and engineers walked the entire site, going through all buildings plant rooms and basements as part of the preliminary planning for the hospital redevelopment.

At the southern end of the campus, work is underway to create a water farm where the swimming pool used to be.

Read on for more information about all these projects.



*Theatre pendants being installed.*

### Whakakatauki

*Ehara taku toa, he takitahi, he toa takitini.*

*My success should not be bestowed onto me alone, as it was not individual success but success of a collective.*

*Source: Ngā Pepeha a ngā Tipuna.*

## UPDATE ON MAJOR BUILDING PROJECT

### ACUTE MENTAL HEALTH UNIT (AMHU)

Two major milestones were achieved this month, with the erection of framing underway and the completion of the foundation.

The framing is much larger than people envisaged and if you haven't had a chance to see it, it is worth a visit. It makes visible the roof design which took its inspiration from the nearby mountain ranges – the Tararuas and the Ruahines.



The glulam structure beams are environmentally sustainable with significantly better carbon impact than steel. They also provide excellent seismic performance and are locally sourced from a Levin-based firm.



You can follow the progress of these projects on our website  
[www.projects.mdhb.health.nz](http://www.projects.mdhb.health.nz)  
or by scanning the QR code.



*First section of framing slowly rising from the ground up with support from the on-site construction crane.*



On 23 August the concrete foundation was completed. This has been a major undertaking, and the project is ahead of schedule for that phase of work.



# SURGICAL PROCEDURAL INTERVENTIONAL RECOVERY EXPANSION (SPIRE)

*New cardiologist meeting Christine Wood, Medical Admin Unit.*

Welcome to Dr Vineet Sankhla who joined the cardiology team this week. He is our first interventional cardiologist and will be working with the team to get everything ready for launching the new service this December when the Cathlab is operational.

The Cath Lab suite is taking shape, and the ceiling of the main room has the steel grids to hold the large and heavy imaging machine.



The fit-out of the new and reconfigured theatres continues.

The walls have been gibbed and painted and now the flooring is going down and joinery installed.

Work on the theatre's main storeroom commenced.



# INFRASTRUCTURE PROJECTS

## WATER FARM

We will soon have enough water stored on site to enable the hospital to operate independent of the Council's water system for seven days. This is part of a wider project covering all essential services, such as water, power, medical gas etc. Five large water tanks are to be installed and the old swimming pool has been removed to make room for these. A lot of work is now being done to get this area ready for the tanks.



# KA ORA KĀINGA RUA – THE REDEVELOPMENT OF PALMERSTON NORTH REGIONAL HOSPITAL

A team of 11 architects and engineers from NZ and Australia were on site for three days this month to assess our current buildings and infrastructure.

They met with a large number of staff to learn what constraints the current facilities impose on the delivery of care, and what an ideal hospital environment would look like.

Iwi and Māori aspirations were obtained, with architects workshopping these with members of our Iwi Māori Partnership Board, Te Pae Ora Paiaaka Whaiora Hauora Māori and Te Aka Whai Ora.

From their assessments and the feedback received, as well as an analysis of a wide range of documents regarding our facilities, they will develop a list of options as to how we can best configure and/or build our facilities to meet future demand.



## Te Whatu Ora

[Health New Zealand](#)

Te Pae Hauora o Ruahine o Tararua  
MidCentral

*“Our Place” keeps you informed of the strategic projects, interim solutions and the supporting infrastructure work being progressed to ensure Palmerston North Regional Hospital is able to meet current and future demand.*

## THE REDEVELOPMENT OF PALMERSTON NORTH REGIONAL HOSPITAL

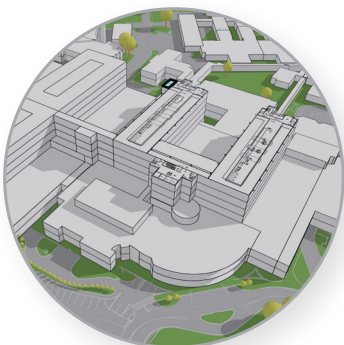

### 1 SHORT-TERM, TACTICAL STOP-GAP SOLUTIONS

- SPIRE
- MAPU-EDOA unit
- ICU and acute care capacity
- Paediatric area in ED

### 2 LONG-TERM, STRATEGIC SOLUTIONS

- Acute services block
- Reconfiguration of the clinical services block
- Acute mental health unit
- Regional cancer centre

### 3 INFRA-STRUCTURE WORKS

- Electrical, heating, ventilation
- Three waters
- Medical gases
- Fire systems
- Thermal and emergency generation systems