

Our Place | Ahu Taumatua

THE REDEVELOPMENT OF PALMERSTON NORTH REGIONAL HOSPITAL

ISSUE 40 | SEPTEMBER 2023

Ahu Taumatua | Our Place brings you all the latest information on the redevelopment projects at Palmerston North Regional Hospital to improve capacity and healthcare in our region.

Learn how our mahi is providing interim solutions and services as we work together to achieve our long-term redevelopment goals to benefit the health of the people in our rohe.

INTRODUCTION

The countdown is on as the SPIRE project heads toward the finish line. The new facilities will be ready by the end of the year with a full and varied work programme between now and then.

The construction of our new Acute Mental Health Unit is drawing a lot of attention as it takes shape, particularly the unique roof line.



The first of our five water tanks will be delivered on site late November and work to get the site prepared is in full swing. This project which ensures us water supply in the event of disaster will be completed April/May 2024.

Planning for new hospital facilities is progressing and our clinical services plan is currently going through the approval process.

Whakakataukī

Ka tangi te pīpīwharauoa, ko te karere a Mahuru.

When the cuckoo cries, that is the herald of spring.

Mahuru is the fourth month of the Māori year, about September-November.

Source: Ngā Pepeha a ngā Tipuna.

UPDATE ON MAJOR BUILDING PROJECTS

ACUTE MENTAL HEALTH UNIT (AMHU)

The shape and size of our new Acute Mental Health Unit is growing by the day. Once completed, the building footprint will be around 2,700 m².

The large glulam structural portal frames get installed, followed by the structural steel purlins and roof framing, and then the roof goes on.

Stage 1, which includes the main entrance, is well advanced, with the roof framing being erected. You will see the roof going on in the first half of October if the weather plays its part.

The glulam structural framing of Stage 2 will be completed in early October, and then Stage 3 will commence. Stage 2 (the largest stage) comprises bedrooms, two courtyards and the central staff area. Stage 3 will accommodate the short stay area, bedrooms, a courtyard, gym and some multipurpose rooms.

Alongside the construction work in the coming weeks, the team will connect the building's water and drainage pipes to the City Council's network.

This project is progressing quickly so be sure to check out our website each week for progress photos.

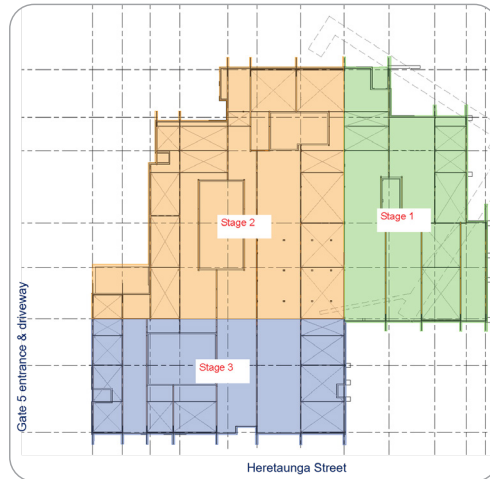

SURGICAL PROCEDURAL INTERVENTIONAL RECOVERY EXPANSION (SPIRE)

We are in the final months of work to complete this project thanks to a huge team effort.

• CATH LAB

Welcome to our two new interventional cardiologists – Doctor Vineet Sankhla and Doctor Ran Eliaz, who joined the Cardiac Interventional Service team. They and the team will oversee the final stages of the new cath lab development.

The large imaging equipment will come on site late October and installation will get underway once the construction work is complete. It is expected the service will be operational by the end of the year.

The introduction of this service is a significant asset for the region, where appropriate patients and whānau in the community will no longer need to travel to Wellington Hospital for time-critical cardiac procedures.



Fit-out of cath lab underway.

• ADDITIONAL THEATRES

The establishment of two additional theatres and the reconfiguration of an existing theatre is on the home straight.

Construction works are scheduled for completion by the end of October and work then begins in getting these cleaned, equipped, clinical equipment commissioned and the area blessed. This involves many services, including theatre, materials management, cleaning, digital services, clinical engineering, to name but a few.



Pendants installed in new theatres.

• PLANT ON ROOFTOP

Work to install the air handling units and other plant on the rooftop is all but complete. This work occurred under a large tent which is now being dismantled. Scaffolding is also being progressively dismantled and moved offsite.



Scaffolding and tent being removed from rooftop.

KA ORA KĀINGA RUA – THE REDEVELOPMENT OF PALMERSTON NORTH REGIONAL HOSPITAL

Good progress continues to be made with the preparatory work required to inform the business case process. A four-stage process is used by Te Whatu Ora and we are in the first stage which “identifies” the issues and key drivers for investment in new and reconfigured facilities and potential options.

Our clinical services plan, which is the fundamental document sets out what services are to be delivered, how they are to be delivered and where from. This document has been drafted and is currently going through the approval process.

An equity plan is in development and sets out what we need to do to move to a pro-equity model and ensure equity will be achieved.

We have an asset management plan in place and this looks at our current assets (buildings, infrastructure, digital and major clinical equipment) and what we need to do to manage these to meet future demand.

Site master planning is underway and determines what hospital and specialist service facilities will be required to deliver the clinical services plan. The team of architects and engineers leading this work will be back on site mid-October.

Once we have a site master plan, data and digital requirements will be calculated.

Stage 1 Identify	Stage 2 Define	Stage 3 Design	Stage 4 Deliver & debrief
<ul style="list-style-type: none"> <input type="checkbox"/> Clinical services plan <input type="checkbox"/> Equity plan <input checked="" type="checkbox"/> Asset management plan <input type="checkbox"/> Site master plan <input type="checkbox"/> Data & digital plan 	<ul style="list-style-type: none"> Programme business case Detailed business case Concept design 	<ul style="list-style-type: none"> Preliminary design Developed design Detailed design 	<ul style="list-style-type: none"> Implementation business case Procurement Construction Completion & evaluation

*You can follow the progress of these projects on our website
www.projects.mdhb.health.nz
 or by scanning the QR code.*



INFRASTRUCTURE PROJECTS

WATER FARM

The groundwork for the water farm is being firmly put in place. Removal of the pool and 'soft spots' is complete and hardfill is now being compacted in preparation for a foundation of which five tanks, containing over 500,000 litres of water each, will be placed. The first three will be delivered late November, and the work will be complete by the end of April 2024, including a water treatment station. Together, the tanks will provide a minimum of seven days water autonomy.

This work is the first stage of three to improve on-site water storage and distribution. Initially, the tanks will be connected to our existing water pipes. As part of Stage 2, a new pipeline with a higher seismic rating, will be installed, delivering water to the main clinical areas.

Stage 3 involves replacing the remaining existing fragile pipeline as well establishing pipework to the new hospital buildings as part of the hospital redevelopment programme.

Stage 2 and 3 will get underway in future years.



6 September 2023

12 September 2023



25 September 2023



Te Whatu Ora Health New Zealand

Te Pae Hauora o Ruahine o Tararua
MidCentral

"Our Place" keeps you informed of the strategic projects, interim solutions and the supporting infrastructure work being progressed to ensure Palmerston North Regional Hospital is able to meet current and future demand.

THE REDEVELOPMENT OF PALMERSTON NORTH REGIONAL HOSPITAL

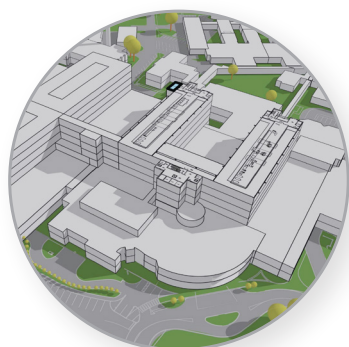

1 SHORT-TERM, TACTICAL STOP-GAP SOLUTIONS

- SPIRE
- MAPU-EDOA unit
- ICU and acute care capacity
- Paediatric area in ED

2 LONG-TERM, STRATEGIC SOLUTIONS

- Acute services block
- Reconfiguration of the clinical services block
- Acute mental health unit
- Regional cancer centre

3 INFRA-STRUCTURE WORKS

- Electrical, heating, ventilation
- Three waters
- Medical gases
- Fire systems
- Thermal and emergency generation systems